

## KA series



### SPECIFICATIONS:

#### 3-JAW STRONG SCROLL CHUCKS A1 DIRECT MOUNTING, 2-PIECE JAWS

(ASA spindle nose A1-5, A1-6)

American standard camlock type with 2-piece reversible hard top jaws.

1. Gripping accuracy of 0.03mm(0.0012inch)T.I.R.
2. Standard accessories A chuck wrench and hex. key. One set of mounting bolts.(UNC-bolts)
3. The body is made of MEEHANITE.It is suitably used for high speed revolution and 3 times more durable than regular chucks.

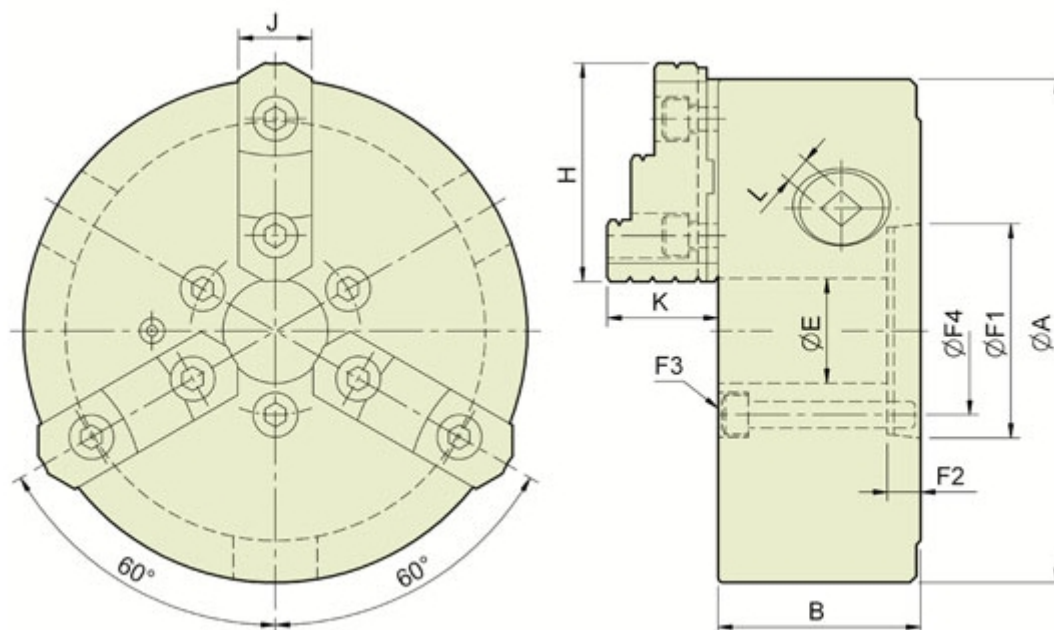

### SPECIFICATIONS:

Dim Model	Spindle Size	A	B	E	L	H	J	K	Mounting Dimensions				Allowable Handle Torque (kgf. m)	Gripping Force (kgf)	Moment of Inertia I (kg. m <sup>2</sup> )	Weight (kg)	Max. Speed (r.p.m.)	Gripping Rang	
									F1	F2	F3	F4						O.D. range	I. D. range
KA5-8"	A-1-5	200	77.2	40	11	81.2	28	42.2	82.5	63	3-M10	61.9	11.0	3600	0.07	18	3200	Ø8-Ø180	Ø62-Ø170
KA6-8"	A-1-6	200	77.2	53	11	82.2	28	42.2	106.3	75	3-M12	82.5	11.0	3600	0.07	18	3200	Ø8-Ø180	Ø62-Ø170
KA6-10"	A-1-6	250	86	53	12	90.9	32	50.8	106.3	75	3-M12	82.5	19.0	4800	0.2	29.5	2500	Ø11-Ø220	Ø70-Ø210
KA6-12"	A-1-6	306	107.5	53	14	114.5	40	57.8	106.3	75	3-M12	82.5	21.0	5100	0.5	47	2200	Ø15-Ø300	Ø90-Ø290
KA8-12"	A-1-8	306	107.5	77	14	114.5	40	57.8	139.7	17	6-M16	111.1	21.0	5100	0.5	47	2200	Ø15-Ø300	Ø90-Ø290